

ORDINANCE NO. 71

The City Council of the City of LeRoy at a regular meeting on March 6, 1978, held at the City Hall, LeRoy, Illinois has considered the Petition for Annexation filed by GLENN STILLE. With regard to said Petition, the City Council finds as follows:

- (1) That the legal description of the property to be annexed and a plat thereof is attached to this Ordinance as Exhibit A.
- (2) The property to be annexed is contiguous to the existing corporate limits of the City of LeRoy.
- (3) That GLENN STILLE is the sole owner of the property to be annexed.
- (4) That there are no electors residing on said premises.
- (5) That the territory to be annexed is now a part of the LeRoy Community Fire Protection District and that the annexation will effect no change and therefore no notice is required to be sent to the said District.
- (6) That Petitioner GLENN STILLE requests that if said territory is annexed, it be given a zoning classification of I-1 Light Industrial.

NOW, THEREFORE, BE IT ORDAINED by the City Council of the CITY of LeROY as follows:

- (1) The territory described is hereby annexed to the City of LeROY, Illinois.
- (2) The City Clerk is directed to record this Ordinance and the Annexation Plat to be provided by Petitioner GLENN STILLE.
- (3) That if the CITY OF LeROY shall fail to rezone the premises described herein to I-1 Light Industrial, then Petitioner shall have the right to petition for disconnection of the territory described herein.

PASSED at a regular meeting of the City Council of the City of LeRoy on March 6, 1978 by a vote of 4 ayes and 0 nays.

Attest:

*Janita Bagley*  
City Clerk

*John W. Moss*  
MAYOR OF THE CITY OF LE ROY

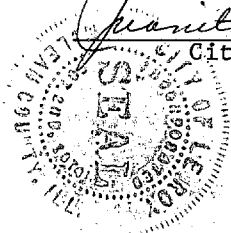

Beginning at the intersection of the south line of Route 150 and the west line of Hemlock St. in the City of LeRoy, Ill; thence South 435 ft. on the west line of Hemlock St. to the north property line of Omni-Tech Systems Inc; thence West 240 ft. to the east property line of the Pillsbury Grain Co.; thence North 444.4 ft. more or less to the south line of Route 150; thence Easterly on the south line of Route 150 to the point of beginning containing 2.42 acres more or less and being situated in the S.W. 1/4 of the N.E. 1/4 of Sec. 20, T 22 N, R 4 E of the 3rd P.M. McLean Co., Illinois.

ANNEXATION PART

BEGINNING AT THE INTERSECTION OF THE SOUTH LINE OF ROUTE 150 AND THE WEST LINE OF HEMLOCK ST. IN THE CITY OF LEROY, ILL.; THENCE SOUTH 435 FT. ON THE WEST LINE OF HEMLOCK ST. TO THE NORTH PROPERTY LINE OF OMNI-TECH SYSTEMS INC.; THENCE WEST 240 FT. TO THE EAST PROPERTY LINE OF THE PILLSBURY GRAIN CO.; THENCE NORTH 444.4 FT. MORE OR LESS TO THE SOUTH LINE OF ROUTE 150; THENCE EASTERLY ON THE SOUTH LINE OF ROUTE 150 TO THE POINT OF BEGINNING CONTAINING 2.42 ACRES MORE OR LESS AND BEING SITUATED IN THE S.W. 1/4 OF THE N.E. 1/4 OF SEC. 20, T 22 N, R. 4 E OF THE 3RD P.M. McLEAN CO., ILL.

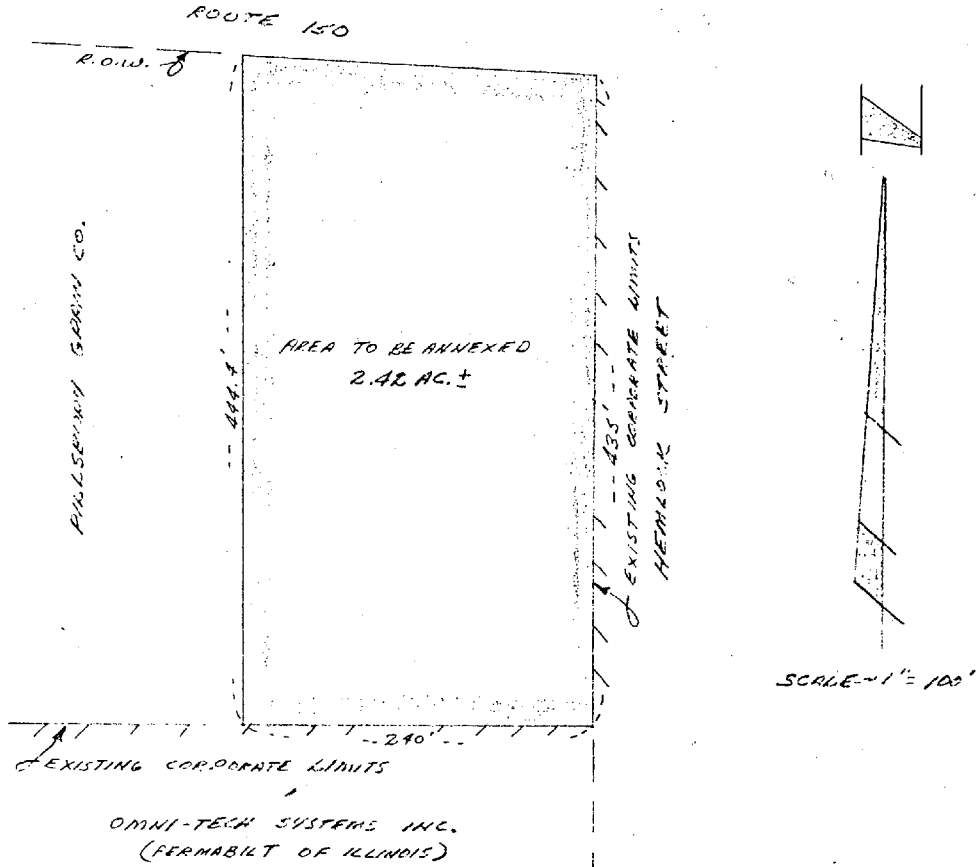

EXHIBIT A

PREPARED BY  
*Percy L. Lewis*  
PERCY L. LEWIS  
ILL. REG. LAND SURVEYOR NO. 1874

# City of LeRoy

**OFFICERS**

JACK W. MOSS  
Mayor

MRS. JUANITA DAGLEY  
City Clerk

ARLO E. BANE  
City Attorney

MRS. MILDRED WHITAKER  
City Treasurer

STATE OF ILLINOIS



**Aldermen**

Ward One  
JACK C. GASSAWAY  
ROBERT E. ABNER

Ward Two  
DENNIS E. HENSON  
LOREN BEAN

Ward Three  
GEORGE COOK  
BRUCE OWENS

STATE OF ILLINOIS:

COUNTY OF MC LEAN:

I, Juanita Dagley, duly elected and qualified City Clerk of the City of Le Roy, McLean County, Illinois, do hereby certify that the foregoing is the original ordinance; that said ordinance was passed on the 6th day of March, 1978 and the record of the final vote on its passage can be found in the minutes of the March 6, 1978 Council meeting.

Juanita Dagley  
City Clerk



78 4901

INDEXED

RECORDED  
INDEXED  
APR 17 1978  
CLERK

MICROFILMED

Mae Deane, Recorder of Deeds

State of Illinois }  
County of McLean } SS

THIS INSTRUMENT FILED FOR RECORD

ON APR 17 1978

AT 12:09 PM AND RECORDED AS

DOCUMENT NUMBER 78-4501

Mae Deane  
Recorder

6-

Wm Allison

210 E Washington

St. Louis, MO