

ORDINANCE NO. 61

An ordinance annexing certain territory to the City of LeRoy, McLean County, Illinois;

BE IT ORDAINED BY THE MAYOR AND CITY COUNCIL OF THE CITY OF LE ROY, ILLINOIS:

WHEREAS, a Petition for annexation to the City of LeRoy executed by Wendell Crumbaugh and Steven Crumbaugh has been duly filed with the City Clerk of the City of LeRoy for annexation to said City of the following described real estate:

Beginning at the S.W. corner of the S.E. $\frac{1}{4}$ of the S.W. $\frac{1}{4}$ of the N.E. $\frac{1}{4}$ of Sec. 21, T. 22N, R. 4 E of the 3rd P.M., thence north on the west line of the S.W. $\frac{1}{4}$ of the N.E. $\frac{1}{4}$ of the said Sec. 21 to the Southern right of way of the Illinois Central Gulf Railroad, thence in a southeastern direction on the said right of way line to a point 195 ft. West of the East line of the S.W. $\frac{1}{4}$ of the N.E. $\frac{1}{4}$ of the said Sec. 21; thence south parallel with the East line of the S.W. $\frac{1}{4}$ of the N.E. $\frac{1}{4}$ of the said Section 21 to the South line of the N.E. $\frac{1}{4}$ of the said Section 21, thence East on the South line of the N.E. $\frac{1}{4}$ of the said Section 21 to the point of beginning containing approx. 1.67 acre and being contiguous to the City of LeRoy, McLean Co., Ill.

WHEREAS, the allegations and recitals set forth in said Petition are in proper form and meet the requirements set forth in the statutes thereto applying, and

WHEREAS, the Petitioners are the owners of record of said territory and there are no electors residing therein, and

WHEREAS, the territory described above and in said Petition is adjacent and contiguous to the City of LeRoy and is not within the corporate limits of any other municipality or any other city, and

WHEREAS, the territory is a part of the LeRoy Community Fire Protection District and that the annexation will effect no change and therefore no notice is required to be sent to the said District; and

WHEREAS, the territory to be annexed is a part of the future subdivision known as "Crumbaugh's Cherry Street Addition", the preliminary plat of which was approved by the City Council on June 6, 1977 and that the territory will be zoned as R-1 in accordance with the City Zoning Ordinance;

NOW THEREFORE, BE IT ORDAINED BY THE MAYOR AND CITY COUNCIL OF THE CITY OF LE ROY, ILLINOIS AS FOLLOWS:

Section 1: The territory as above described is hereby annexed to and declared to be an integral part of the City of LeRoy, Illinois;

Section 2: This ordinance shall be effective from and after its passage and publication and the City Clerk is directed to file with the Recorder of Deeds, McLean County, Illinois, a certified copy hereof, together with an accurate map of the annexed territory.

4 years

0 days

APPROVED:

Jack W. Moss
Mayor

ATTEST:

Juanita Dogley
City Clerk

PASSED BY THE CITY COUNCIL OF THE CITY OF LE ROY, ILLINOIS, THIS 18th DAY OF July, 1977.



INDEXED 77 10562

CLERK OF COURTS
JUL 21 1977
MCLAIN COUNTY
ILLINOIS

MICROFILMED

Mae Deane, Recorder of Deeds
State of Illinois }
County of McLean } SS
THIS INSTRUMENT FILED FOR RECORD
ON JUL 21 1977
AT 2:02 P.M. AND RECORDED AS
DOCUMENT NUMBER 77-10562
Mae Deane
Recorder

7-
City Clerk for Roy
for Roy, all.

This is a copy of the original map
 showing the location of the site of the
 proposed project. The map shows the
 location of the site relative to the
 surrounding roads and landmarks. The
 site is located on the corner of
 the intersection of the road and
 the road. The map shows the
 location of the site relative to the
 surrounding roads and landmarks. The
 site is located on the corner of
 the intersection of the road and
 the road. The map shows the
 location of the site relative to the
 surrounding roads and landmarks.

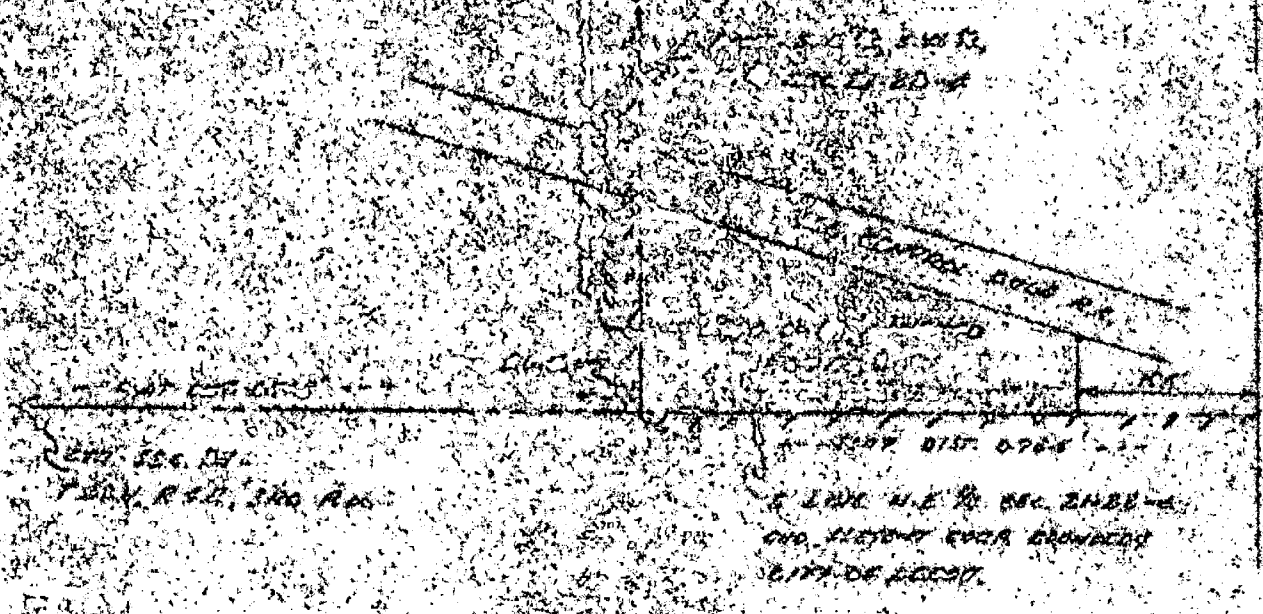

EXHIBIT A

APPROVED BY THE CITY COMMISSIONER
 OR LEGAL COUNSEL THIS 15th DAY OF
 JULY, 1977

[Signature]
 CITY COMMISSIONER

[Signature]
 LEGAL COUNSEL

APPROVED BY
[Signature]
 CITY COMMISSIONER
 JULY 15, 1977

ROY M. CROWN ST.

PRELIMINARY PLAT

CUMBERLAND'S CHERRY STREET INDUSTRIAL

CITY OF BERKELEY

ROBERTSON CO., INC.

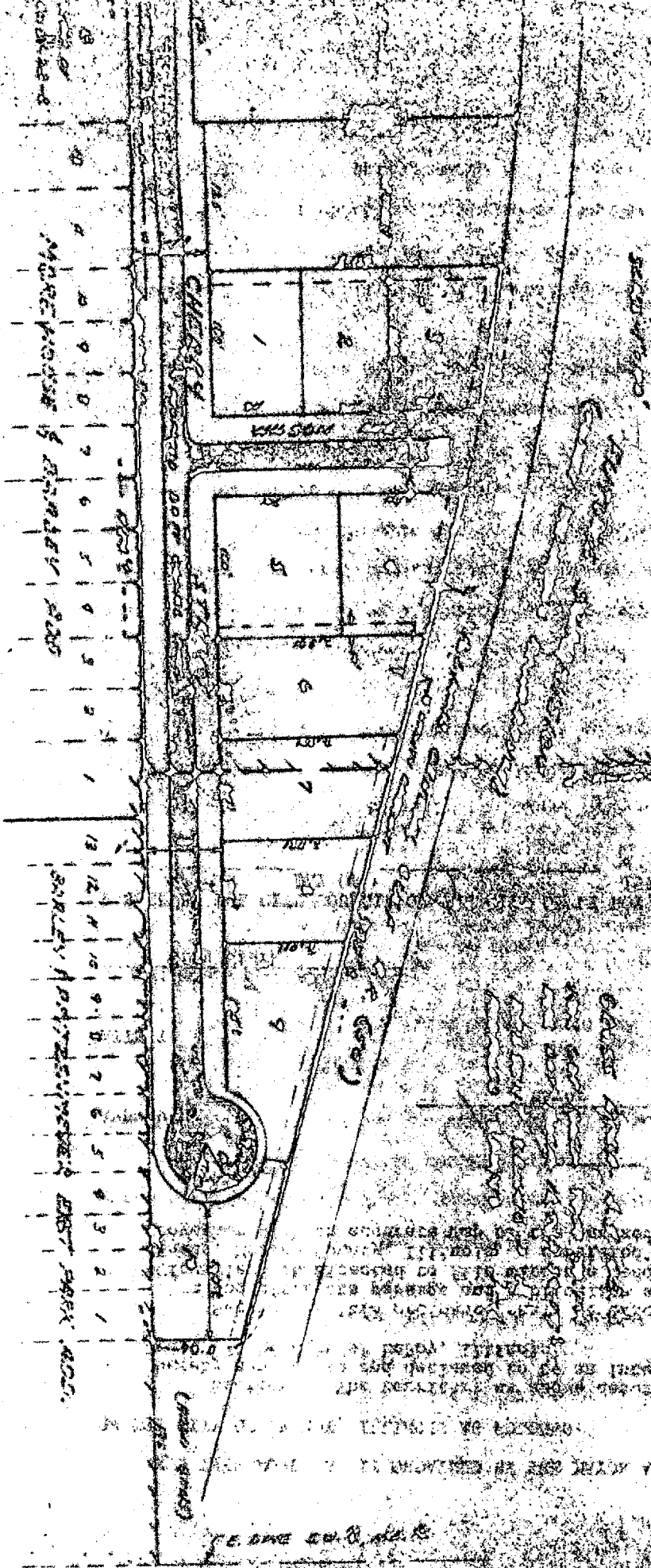
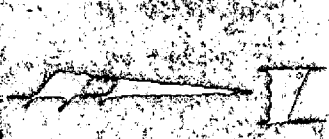

13 12 11 10 9 8 7 6 5 4 3 2 1

13 12 11 10 9 8 7 6 5 4 3 2 1

E. DAVE CO., INC.